



# **SIMpull MC™ THHN/THWN Circuit Size Copper Conductor 277/480V Colors**

Copper THHN/THWN Insulated Singles. Green Insulated Copper Grounding Conductor. UL Listed. 600 Volts Rated VW-1. Lightweight Aluminum Interlocked Armor.

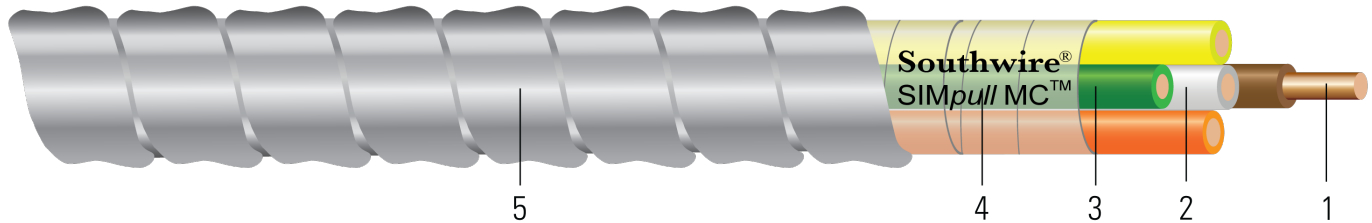

Image not to scale. See Table 1 for dimensions.

## **CONSTRUCTION:**

1. **Conductor:** Solid copper per ASTM B3 or 19-strand class C compressed copper per ASTM B3 and B8
2. **Insulation:** Polyvinyl Chloride with Nylon Sheath Type THHN/THWN
3. **Ground:** Green Polyvinyl Chloride with Nylon Sheath Type THHN/THWN insulated ground conductor
4. **Binder:** Mylar tape
5. **Armor:** Aluminum Interlocked Armor

## **APPLICATIONS AND FEATURES:**

**Southwire SIMpull MC™ Cable is suitable for use as follows:**

- Branch, feeder and service power distribution in commercial, industrial, institutional, and multi-residential buildings
- Fished or embedded in plaster
- Concealed or exposed installations
- Environmental air-handling spaces per NEC 300.22 (C)
- Places of Assembly per NEC 518.4 and theaters per NEC 520.5
- Installation in cable tray and approved raceways
- Under raised floors for information technology equipment conductors and cables per NEC Article 645
- Binder tape with print legend wrapped around assembly
- Type THHN/THWN rated 90°C dry
- Unjacketed Type MC cables are rated for dry, indoor locations only per NEC 330.10(A)(10)
- Anti-Short bushing not required

**Southwire SIMpull MC™ Cable meets or exceeds the following requirements:**

- UL Online Product Guide Info - Metal-Clad Cable (PJAZ) ( [www.ul.com](http://www.ul.com) )
- Federal Specification A-A59544 (formerly J-C-30B)
- NFPA 70 (National Electrical Code), Article 330
- Listed for use in UL 1, 2 and 3 Hour Through Penetration Firestop Systems

## **SPECIFICATIONS:**

- ASTM B3 Soft or Annealed Copper Wire
- ASTM B8 Concentric-Lay-Stranded Copper Conductors





- UL 83 Thermoplastic Insulated Wires and Cables
- UL 1569 Metal-Clad Cables
- UL 1479 Standard for Safety Fire Tests of Penetration Firestops
- UL 1685 FT4 Vertical-Tray Fire Propagation and Smoke Release Test
- IEEE 1202 FT4 Flame Test (70,000) BTU/hr Vertical Tray Test
- RoHS-2 (European Directive 2011/65/EU)
- Made in America: Compliant with both Buy American and Buy America Act (BAA) requirements per 49 U.S.C. § 5323(j) and the Federal Transit Administration Buy America requirements per 49 C.F.R. part 661
- VW-1 (Vertical-Wire) Flame Test

**SAMPLE PRINT LEGEND:**

SOUTHWIRE E96627 {UL} TYPE MC XX AWG THHN OR THWN CDRS FOR USE IN CABLE TRAYS 600 VOLTS

**Table 1 – Weights and Measurements**

Stock Number	Cond. Size	Conductor Number	Color	Diameter Over Conductor	Conductor Stranding	Insulation Thickness	Ground Size	Diameter Over Armor	Copper Weight	Overall Weight
	AWG/ Kcmil			inch		mils	No. x AWG	inch	lbs/1000ft	lbs/1000ft
10 AWG   Solid										
665380	10	2	BN,GY	0.101	Solid	25	1x10	0.518	92	147

All dimensions are nominal and subject to normal manufacturing tolerances

◊ Cable marked with this symbol is a standard stock item

**Note:** Conductor number = number of phase conductors. Does not include green ground.

**Table 2 – Electrical and Engineering Data**

Cond. Size	Conductor Number	Min. Bend Radius	DC Resistance at 25°C	AC Resistance at 75°C	Inductive Reactance @ 60Hz	Allowable Ampacity Raceway 75°C	Allowable Ampacity Raceway 90°C
AWG/ Kcmil		Inches	Ω/1000ft	Ω/1000ft	Ω/1000ft	Amp	Amp
10 AWG   Solid							
10	2	3.6	1.040	1.253	0.050	35	40

\* Ampacities based upon 2023 NEC Table 310.16 and do not take into account the overcurrent protection limitations in NEC 240.4(D) of 15 Amps for 14 AWG CU, 20 Amps for 12 AWG CU, and 30 Amps for 10 AWG CU (independent of the conductor temperature rating and stranding if size is present in table). Also, see NEC sections 310.15 and 110.14(C) for additional requirements.

\* Ampacities have been adjusted for more than Three Current-Carrying Conductors.

