



SIMpull™ Couplers: E-LOC Conduit Coupling

E-LOC & E-LOC Couplings

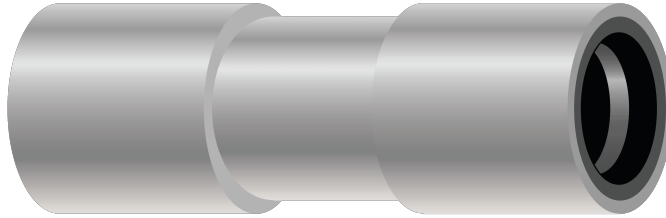

Image not to scale. See Table 1 for dimensions.

CONSTRUCTION:

- Can join ducts made from dissimilar materials
- Can withstand 200 psi restrained on smooth wall conduit
- Size range from 3/4" through 4"
- Transitions between sizes available
- No additional tooling required for installation

APPLICATIONS AND FEATURES:

- The E-LOC Coupling is a compression coupling that provides a watertight/airtight connection in buried, or restrained applications. The ability to join dissimilar materials, such as PVC, HDPE, fiberglass, or metal, makes the E-LOC a versatile coupling for the telephone, electrical, and cable industries. Patented.
- E-LOC Couplings are available to fit conduit sizes from 3/4" through 4". Easy to install without the need for additional tools or equipment. Watertight to 200 psi restrained on smooth wall conduit. Also seals on ribbed and corrugated duct. Custom lengths and non-standard IPS diameters are available. Allows for transitions between different materials with one coupling.
- E-LOC Transition Couplings have all the great features of an E-LOC Coupling while providing a transition from one size conduit to another. This includes the ability to transition to dissimilar materials such as PVC, HDPE, fiberglass, and metal. Allows for transitions between different sizes and materials with one coupling.

E-LOC Couplings

Stock Number	REFERENCE	NOMINAL SIZE inch	STANDARD DUCT SIZE	COUPLING BODY O.D. inch	LENGTH inch	PIECES PER CARTON	WEIGHT PER CARTON lbs
631229	EL-105	0.75	1.050" 3/4" IPS	1.315	4.5	100	28
631246	EL-131	1	1.315" 1" IPS & SCH 40	2	5.25	50	23
604332	EL-166	1.25	1.660" 1.25" IPS	2.4	5.25	50	28
607425	EL-190	1.5	1.900" 1.5" IPS	2.65	6	25	19
606706	EL-237	2	2.375" 2" IPS	3.17	6	25	25
649742	EL-287	2.5	2.875" 2.5" IPS	3.5	6	24	46
649743	EL-350	3	3.500" 3" IPS	4.5	6	18	38
	EL-350-8	3	3.500" 3" IPS x 8" LG	4.5	8	12	42
	EL-350-12	3	3.500" 3" IPS x 12" LG	4.5	12	12	50
	ELR-350	3	3.500" REPAIR SLEEVE	4.5	6	18	38
604418	EL-400	4	4.500" 4" IPS	5.563	6	12	34

*Standard coupling length is 6" unless noted otherwise.



E-LOC Transition Coupling

REFERENCE	DESCRIPTION
ELA-166105	CPLG, E-LOC TRANS 1.660" x 1.050"
ELA-166131	CPLG, E-LOC TRANS 1.660" x 1.315"
ELA-190131	CPLG, E-LOC TRANS 1.900" x 1.315"
ELA-190166	CPLG, E-LOC TRANS 1.900" x 1.660"
ELA-237131	CPLG, E-LOC TRANS 2.375" x 1.315"
ELA-237166	CPLG, E-LOC TRANS 2.375" x 1.660"
ELA-237190	CPLG, E-LOC TRANS 2.375" x 1.900"
ELA-287237	CPLG, E-LOC TRANS 2.875" x 2.375"
ELA-350190	CPLG, E-LOC TRANS 3.500" x 1.900"
ELA-350237	CPLG, E-LOC TRANS 3.500" x 2.375"
ELA-350287	CPLG, E-LOC TRANS 3.500" x 2.875"
ELA-450237	CPLG, E-LOC TRANS 4.500" x 2.375"
ELA-450287	CPLG, E-LOC TRANS 4.500" x 2.875"
ELA-450350	CPLG, E-LOC TRANS 4.500" x 3.500"