

SIMpull MC™ THHN/THWN Circuit Size Copper Conductor 120/208V Colors

Copper THHN/THWN Insulated Singles. Green Insulated Copper Grounding Conductor. UL Listed. 600 Volts Rated VW-1. Lightweight Low Profile Aluminum Interlocked Armor.

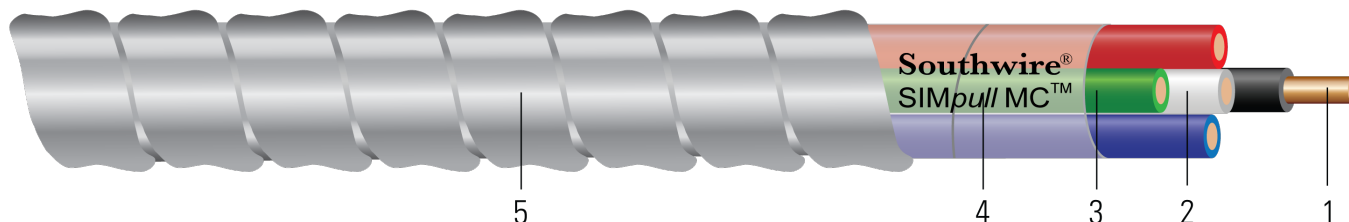

Image not to scale. See Table 1 for dimensions.

CONSTRUCTION:

- Conductor:** Solid or 19 strands class C compressed copper per ASTM B3 and ASTM B8
- Insulation:** All phases are insulated with Polyvinyl Chloride with Nylon Sheath Type THHN/THWN
- Ground:** Green insulated ground. Polyvinyl Chloride with Nylon Sheath Type THHN/THWN
- Binder:** Mylar tape with print legend wrapped around assembly.
- Armor:** Low Profile Aluminum Interlocked Armor

APPLICATIONS AND FEATURES:

- Southwire SIMpull MC™ Cable is suitable for use as follows:
- Branch and service power distribution in commercial, industrial, institutional, and multi-residential buildings.
- Fished or embedded in plaster.
- Concealed or exposed installations.
- Environmental air-handling spaces per NEC 300.22 (C).
- Places of Assembly per NEC 518.4 and theaters per NEC 520.5.
- Installation in cable tray and approved raceways.
- Under raised floors for information technology equipment conductors and cables per NEC Article 645
- Binder tape with print legend wrapped around assembly.
- Type THHN/THWN rated 90°C Dry.
- Anti-Short bushing not required

Southwire SIMpull MC™ Cable - meets or exceeds the following requirements:

- UL Online Product Guide Info - Metal-Clad Cable (PJAZ) (www.ul.com)
- Federal Specification A-A59544 (formerly J-C-30B)
- NFPA 70 (National Electrical Code), Article 330
- Listed for use in UL 1, 2 and 3 Hour Through Penetration Firestop Systems

SPECIFICATIONS:

- ASTM B3 Soft or Annealed Copper Wire
- ASTM B8 Concentric-Lay-Stranded Copper Conductors
- UL 83 Thermoplastic Insulated Wires and Cables
- UL 1569 Metal-Clad Cables



Southwire Company, LLC | One Southwire Drive, Carrollton, GA 30119 | www.southwire.com

Copyright © 2023 Southwire Company, LLC. All Rights Reserved



Southwire

**CABLETECH
SUPPORT™**

Services

UPDATED: Aug. 30, 2023, 4:09 p.m. UTC REVISION: 1.000.012

- UL 1479 Standard for Safety Fire Tests of Penetration Firestops
- UL 1685 FT4 Vertical-Tray Fire Propagation and Smoke Release Test
- IEEE 1202 FT4 Flame Test (70,000) BTU/hr Vertical Tray Test
- REACH/RoHS-2 (Chemical Limit) Compliant
- Made in America: Compliant with both Buy American and Buy America Act (BAA) requirements per 49 U.S.C. § 5323(j) and the Federal Transit Administration Buy America requirements per 49 C.F.R. part 661
- VW-1 (Vertical-Wire) Flame Test

SAMPLE PRINT LEGEND:

SOUTHWIRE E96627 {UL} TYPE MC XX AWG THHN OR THWN CDRS FOR USE IN CABLE TRAYS 600 VOLTS



Table 1 – Weights and Measurements

Stock Number	Cond. Size	Conductor Number	Color	Diameter Over Conductor	Conductor Stranding	Insulation Thickness	Ground Size	Diameter Over Armor	Overall Weight
	AWG/ Kcmil			inch		mils	No. x AWG	inch	lbs/1000ft
137914	14	2	BK/WE	0.064	Solid	20	1x14	0.415	76
TBA	14	3	BK/WE/BE	0.064	Solid	20	1x14	0.442	98
665383	14	3	BK/WE/RD	0.064	Solid	20	1x14	0.442	94
TBA	14	4	BK/RD/BE/ WE	0.064	Solid	20	1x14	0.508	116
665378	12	2	BE/WE	0.080	Solid	20	1x12	0.451	104
137912	12	2	BK/WE	0.080	Solid	20	1x12	0.451	104
665377	12	2	RD/WE	0.080	Solid	20	1x12	0.451	104
137918	12	2	BN/GY	0.080	Solid	20	1x12	0.451	104
665381	12	2	OE/GY	0.080	Solid	20	1x12	0.451	104
665382	12	2	YW/GY	0.080	Solid	20	1x12	0.451	104
665387	12	3	BN/OE/GY	0.080	Solid	20	1x12	0.482	129
665436	12	3	BK/RD/BE	0.080	Solid	20	1x12	0.482	129
137913	12	3	BK/RD/WE	0.080	Solid	20	1x12	0.482	129
665384	12	4	BK/RD/BE/ WE	0.080	Solid	20	1x12	0.517	156
TBA	12	4	BK/RD/BE/ WE	0.080	Solid	20	1x12	0.553	162
665379	10	2	RD/WE	0.101	Solid	25	1x10	0.518	148
TBA	10	2	BE/WE	0.101	Solid	25	1x10	0.554	154
665380	10	2	BN/GY	0.101	Solid	25	1x10	0.518	147
137917	10	2	BK/WE	0.101	Solid	25	1x10	0.518	147
137916	10	3	BK/RD/WE	0.101	Solid	25	1x10	0.557	188
TBA	10	4	BK/RD/BE/ WE	0.101	Solid	25	1x10	0.637	235
TBA	14	2	BK/WE	0.073	19	20	1x14	0.468	83
TBA	14	3	BK/WE/RD	0.073	19	20	1x14	0.497	103
137915	12	2	BK/WE	0.090	19	20	1x12	0.472	107
665385	12	3	BK/RD/WE	0.090	19	20	1x12	0.506	135
TBA	12	4	BK/RD/BE/ WE	0.090	19	20	1x12	0.580	169
665386	10	2	BK/WE	0.117	19	25	1x10	0.551	160
TBA	10	3	BK/RD/BE	0.117	19	25	1x10	0.630	209
TBA	10	4	BK/RD/BE/ WE	0.117	19	25	1x10	0.678	254

All dimensions are nominal and subject to normal manufacturing tolerances

◊ Cable marked with this symbol is a standard stock item

Note: Conductor number = number of phase conductors plus neutral. Does not include green ground.



Table 2 – Electrical and Engineering Data

Cond. Size	Conductor Number	Min. Bend Radius	DC Resistance at 25°C	AC Resistance at 75°C	Inductive Reactance @ 60Hz	Allowable Ampacity Raceway 60°C	Allowable Ampacity Raceway 75°C	Allowable Ampacity Raceway 90°C
AWG/ Kcmil		Inches	Ω/1000ft	Ω/1000ft	Ω/1000ft	Amp	Amp	Amp
14	2	3.1	2.631	3.170	0.032	15	20	25
14	3	3.3	2.631	3.170	0.032	15	20	25
14	3	3.1	2.631	3.170	0.040	15	20	25
14	4	3.5	2.631	3.170	0.040	12	16	20
12	2	3.4	1.662	2.002	0.030	20	25	30
12	2	3.4	1.662	2.002	0.030	20	25	30
12	2	3.4	1.662	2.002	0.030	20	25	30
12	2	3.4	1.662	2.002	0.030	20	25	30
12	2	3.4	1.662	2.002	0.030	20	25	30
12	2	3.4	1.662	2.002	0.030	20	25	30
12	3	3.6	1.662	2.002	0.030	20	25	30
12	3	3.6	1.662	2.002	0.030	20	25	30
12	3	3.6	1.662	2.002	0.030	20	25	30
12	4	3.5	1.662	2.002	0.039	16	20	24
12	4	3.8	1.662	2.002	0.038	16	20	24
10	2	3.8	1.040	1.253	0.030	30	35	40
10	2	3.8	1.040	1.253	0.030	30	35	40
10	2	3.8	1.040	1.253	0.030	30	35	40
10	2	3.8	1.040	1.253	0.030	30	35	40
10	3	4.1	1.040	1.253	0.030	30	35	40
10	4	4.4	1.040	1.253	0.038	24	28	32
14	2	3.2	2.631	3.170	0.031	15	20	25
14	3	3.4	2.631	3.170	0.031	15	20	25
12	2	3.5	1.662	2.002	0.030	20	25	30
12	3	3.7	1.662	2.002	0.030	20	25	30
12	4	4.0	1.662	2.002	0.038	16	20	24
10	2	4.1	1.040	1.253	0.029	30	35	40
10	3	4.4	1.040	1.253	0.029	30	35	40
10	4	4.7	1.040	1.253	0.037	24	28	32

* Ampacities based upon 2023 NEC Table 310.16 and do not take into account the overcurrent protection limitations in NEC 240.4(D) of 15 Amps for 14 AWG CU, 20 Amps for 12 AWG CU, and 30 Amps for 10 AWG CU (independent of the conductor temperature rating and stranding if size is present in table). Also, see NEC sections 310.15 and 110.14(C) for additional requirements.

* Ampacities have been adjusted for more than Three Current-Carrying Conductors.

